

Linear Measuring Technology

Length measuring kits	Length measuring kit with encoder	incl. measuring wheel
-----------------------	-----------------------------------	-----------------------

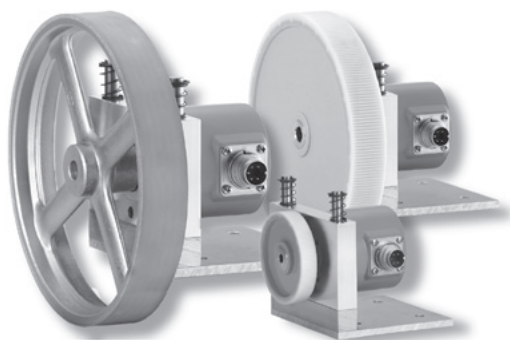

The (metric) measuring kit is a complete solution for the quick and simple implementation of length measurements on products in movement.

Flexible

- Various measuring wheels for various applications:
 - Hytrel for the textile industry
 - Vulkollan for the wood, paper, metal and plastics industry
- Resolution 1 mm

Easy operation

- The encoder support ensures an optimal load on the encoder shaft.
- No additional power supply is required for the encoder, since it can be powered directly by the preset counter.

Single components

Flexible holding device for encoders

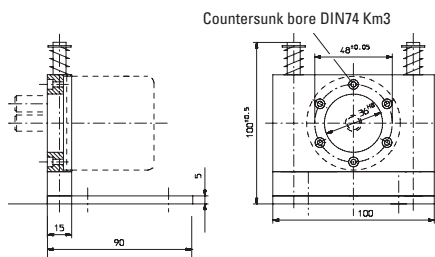

Guide rods Flange

stainless steel
Al

8.0010.7000.0004

Spring encoder arm (s. page 286)

8.0000.7000.010

Measuring wheels (s. page 285)

0.2 m measuring wheel, plastic (Hytrel) corrugated

8.0000.3291.0010

0.5 m measuring wheel, plastic (Vulkollan) smooth

8.0000.3552.0010

0.5 m measuring wheel, plastic (Hytrel) corrugated

8.0000.3592.0010

Encoder

type 5000 for 0.2 m measuring wheel, 1 mm resolution

8.5000.8354.0200

type 5000 for 0.5 m measuring wheel, 1 mm resolution

8.5000.8354.0500

Standard cordset

with 2 m PVC cable, M12

05.WAKS8-2/P00

Preset counter

716 LED preset counter, 90 - 260 V AC, 1 preset

6.716.010.000

Linear Measuring Technology

Accessories

Measuring wheels

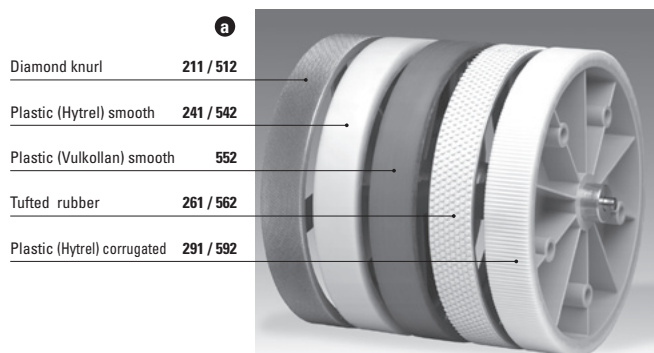

Diamond knurl	211 / 512
Plastic (Hytrel) smooth	241 / 542
Plastic (Vulkollan) smooth	552
Tufted rubber	261 / 562
Plastic (Hytrel) corrugated	291 / 592

Measuring wheels are utilized in combination with encoders to measure material in the wood, paper, metal, textile and plastic industry.

When selecting a measuring wheel, the first consideration is the type of material to be measured as this serves as the basis for determining the surface finish or coating of the measuring wheel.

Various diameters, designed for use with Kübler encoders, available for metric and imperial systems.

Selection of the measuring wheel profile according to the surface of the measured material

Surface of the measured material	Recommended profile no.
Cardboard	1, 2, 3, 6
Wood	1, 2, 3, 6
Textile	1, 4, 5
Plastic (e.g. PVC, PE, ...)	2, 3, 6
Paper	2, 3, 6
Wire	3, 6
Bare metals	4
Varnished surfaces	4

Please note:

If a measuring wheel is mounted directly on the shaft of a rotary encoder, the pressure force between the measuring wheel and measured material should not exceed the radial shaft load listed in the data sheet of the encoder.

In addition, the measuring wheels can only be used for in-house purposes which are not subject to the stipulations of the German calibration code.

Order code Measuring wheels

8.0000 . 3 XXX . 00 XX
a b

Measuring wheel Circumference / ϕ / width	Profile mea- suring wheels (s. o.)	Coating	Coating hardness A	Wheel No. a	Material of wheel body [mm]	Working temperature [°C]	Weight [g]	Standard- bore b [mm] ¹⁾
0,2 m / ϕ 63,7 mm / 12 mm	1	diamond knurl		211	aluminium	—	40	04, 06, 10
	2	plastic (Hytrel) smooth	85 ... 90	241	plastic	-10 ... +50	35	04, 06, 10
	4	tufted rubber		261	aluminium	-10 ... +50	40	06, 10
	5	plastic (Hytrel) corrugated	85 ... 90	291	plastic	-10 ... +70	35	04, 06, 10
0,5 m / ϕ 159,2 mm / 25 mm	1	diamond knurl		512	aluminium	—	350	10
	2	plastic (Hytrel) smooth	85 ... 90	542	plastic	-10 ... +50	260	10
	3	plastic (Vulkollan) smooth	85 ... 90	552	aluminium	-30 ... +80	320	10
	4	tufted rubber		562	aluminium	-30 ... +80	320	10, 12
	5	plastic (Hytrel) corrugated	85 ... 90	592	plastic	-30 ... +80	260	06, 10
12" / ϕ 3,82" / 0,38"	6	Natural rubber (NR) (smooth)	70 ... 75	751	aluminium	-30 ... +80	100	10

Dimensions

Measuring wheels No. 2XX

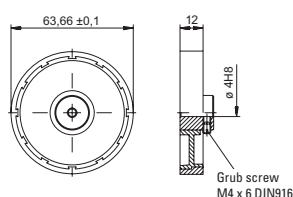

Measuring wheels No. 5XX

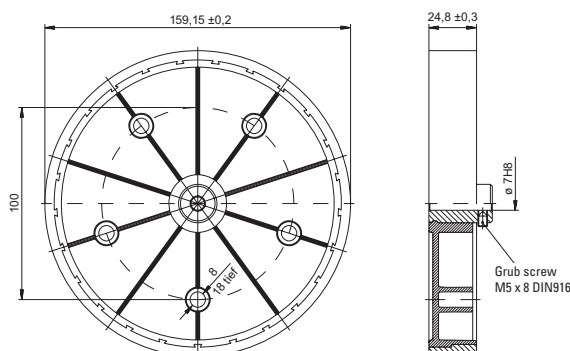

1) Other bore diameters on request

Linear Measuring Technology

Accessories

Spring encoder arm



Robust and reliable

- Max. 40 N, adjustable spring pressure available in any position
Pressure for each notch appr. 20 N (first notch between 0 and appr. 20 N)
- Wide temperature range -40°C ... 120°C

Versatile

- Can be installed in any mounting position 9 setting positions in 40° steps
- Base plate – variable in 4 directions

Order No.

8.0010.7000.0010

Dimension

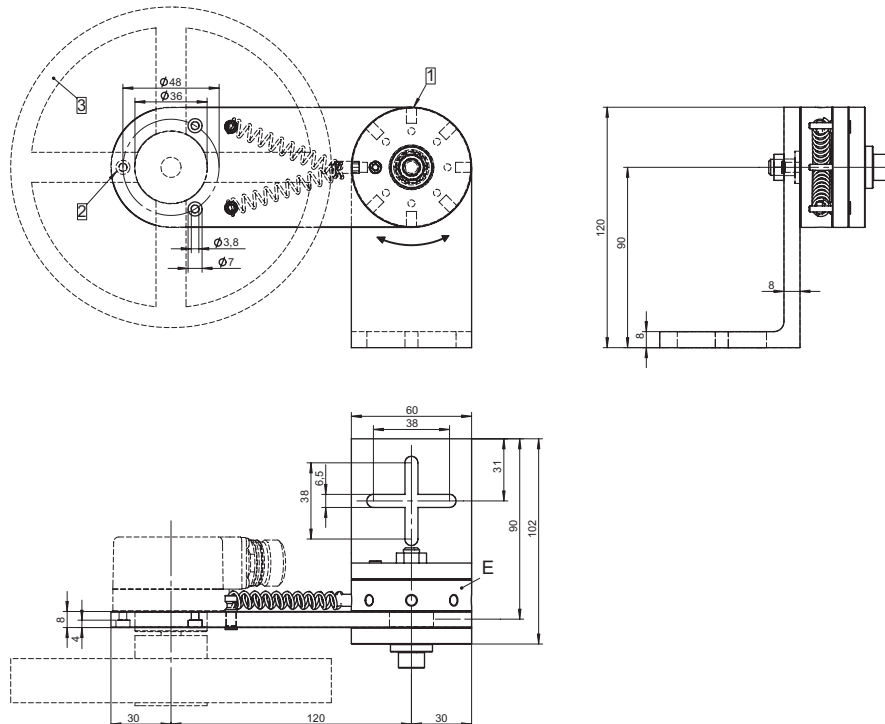

- 1 Setting with a size 0 or 1 screwdriver
- 2 3 pcs. screws M3 x 8 DIN 912 included
- 3 Measuring wheel